

**xiaomi**

Hair Clipper User Manual



Read this manual carefully before use, and retain it for future reference.

## Precautions

---

- This appliance is not intended for use by persons (including children) with reduced physical, sensory or mental capabilities, or lack of experience and knowledge, unless they have been given supervision or instruction concerning use of the appliance by a person responsible for their safety.
- Children should be supervised to ensure that they do not play with the appliance.
- Cleaning and user maintenance shall not be made by children without supervision.

## Europe - EU declaration of conformity

 We shenzhen Kolamama Technology Co., Ltd., hereby, declares that this equipment is in compliance with the applicable Directives and European Norms, and amendments. The full text of the EU declaration of conformity is available at the following internet address:  
<http://www.mi.com/global/service/support/declaration.html>

## WEEE Disposal and Recycling Information



All products bearing this symbol are waste electrical and electronic equipment (WEEE as in directive 2012/19/EU) which should not be mixed with unsorted household waste. Instead, you should protect human health and the environment by handing over your waste equipment to a designated collection point for recycling of waste electrical and electronic equipment, appointed by the government or local authorities. Correct disposal and recycling will help prevent potential negative consequences to the environment and human health. Please contact the installer or local authorities for more information about the location as well as terms and conditions of such collection points.

## WARNINGS

- This appliance contains built-in lithium-ion battery.
- Do not disassemble, impact, crush the battery or throw it into fire.
- If there is severe swelling, do not continue to use.
- Do not leave the battery in high temperature environment.
- For the purposes of recharging the battery, only use the detachable supply unit provided with this appliance.
- Use only with <A520-050100U-EU1> supply unit.
- This appliance contains batteries that are non-replaceable.
- The appliance is intended for trimming purposes only.
- Cutting blades may become hot after prolonged use.

## CAUTIONS

If the battery has leaked and you accidentally touch it, rinse the area with plenty of water and seek medical attention immediately.



Suitable for cleaning under an open water tap.

# Product Overview

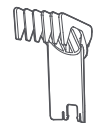
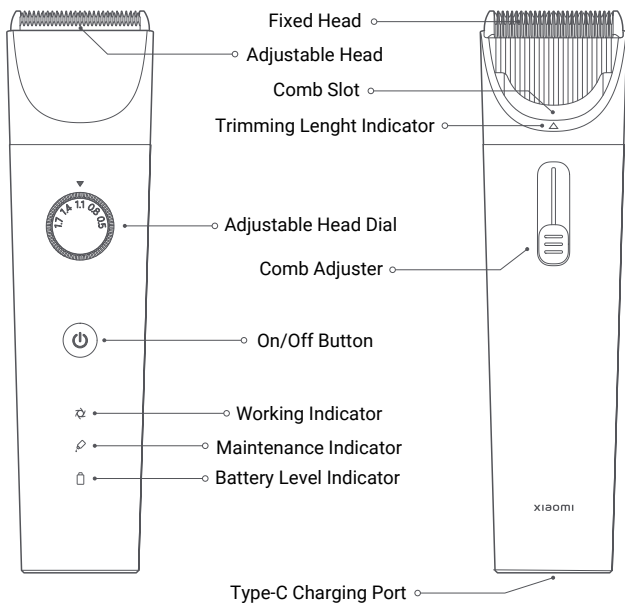

3-21 mm  
Adjustable Comb



23-41 mm  
Adjustable Comb



Thinning  
Comb



Hair  
Clip



Charging Cable



Cleaning Brush



Power Adapter



Sponge

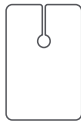

Barber Cape

## Assembly & Disassembly

---

### I. Assembling the comb

To Install a comb, insert the numbered end into the slot until it clicks into place.

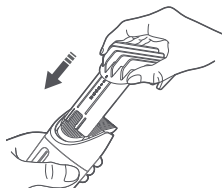

### II. Removing the comb

As shown in the image, hold the top of the comb and pull it upwards to remove it.

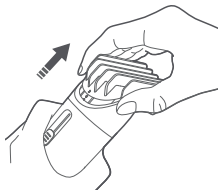

Note:

You can also attach and remove the thinning comb as shown above.

### III. Attaching the blade head

1. Using the dial, set the adjustable head to 1,7 mm.

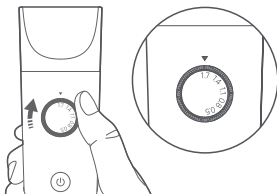

2. To instal the blade head, align clip (A) on the blade head with slot (B) on the clipper, then firmly press the blade head until clicks into place.



#### IV. Removing the blade head

Turn off the power and hold the clipper with the front facing up, as shown in the image. Place your thumb against the blade head and push firmly to remove it.

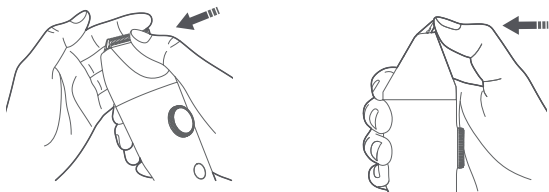

## CAUTIONS

1. To avoid dropping or breaking the blade head, push with one hand and use the other hand to catch it when removing it.
2. If the blade head is damaged, it can cause hair to get stuck or the blade head to not work, so please replace the blade head as soon as possible.
3. When in use, the blade head will heat up slightly. This is normal and does not affect use.
4. The service life of the blade head depends on the frequency of use and maintenance.

# How to Use

---

## Charging

1. Before charging, make sure the clipper is turned off.
2. Plug the charging cable into the charging port on the clipper, and use the provided power adapter to charge the clipper. The battery level indicator will blink white slowly when charging and will remain white once fully charged.

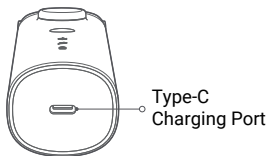

3. It should take about 2,5 hours to fully charge the clipper.
4. The fully charged clipper should run for about 180 minutes.
5. If the battery is running low, the battery level indicator will light up red. You can continue to use the clipper after connecting it to a power source.



## Note:

Connect the clipper to a power source and wait a few seconds before turning it on again. If the battery is depleted before charging, please wait a few minutes before turning it back on.

## On/Off button

Operation	Clipper status
Press	On/off

## Indicators

	Clipper status	Indicator status
	On	Always white
	Off	Off
	Blade head needs oil.	Always white
	Blade head is working normally.	Off
	Sufficient battery	Always white
	Low battery	Always red
	Battery is depleted.	Blinks red 3 times then turns off
	Charging	Blinks white slowly
	Fully charged	Always white

## Using the comb

1. Use a comb to brush the hair in the direction of the hair growth.
2. Choose a suitable comb and attach it to the clipper.
3. As shown in the image, slide the comb adjuster up and down to change the trimming length. The number shown by the trimming length indicator is the length of the hair left after trimming.
4. Place the teeth of the comb on the scalp and move the clipper slowly against the direction of hair growth.

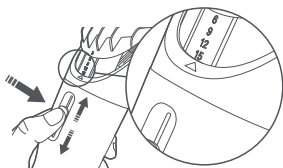

Slide to adjust the trimming length





## Notes:

1. Start trimming at a longer length, and gradually reduce the setting until you reach the desired length.
2. Use a higher speed setting when trimming thick or coarse hair and a lower speed setting when trimming finer hair.
3. When using a comb, it is recommended to set the adjustable head dial to 0,5 mm, otherwise the final hair length may be different from the selected comb length.
4. The length of the hair after trimming will differ slightly from the trimming length.

## CAUTIONS

1. Before using the clipper, make sure that the hair is clean and dry. Do not use the clipper on wet, freshly washed hair.
2. Be careful when trimming for the first time. Do not move the clipper too fast and make sure to move it smoothly and gently.
3. In the case of broken skin, infection or swelling on the scalp, do not use the clipper to prevent any secondary injury.

Select the adjustable comb or thinning comb depending on the desired hairstyle.

	3 - 21 mm Adjustable Comb	It achieves a length of 3 - 21 mm after trimming, has seven lengths to choose from and is best suited for shorter hairstyles.
	23 - 41 mm Adjustable Comb	It achieves a length of 23 - 41 mm after trimming, has seven lengths to choose from and is best suited for medium-length hairstyles.
	Thinning Comb	For trimming layers and ends.



Move the clipper against the direction of hair growth

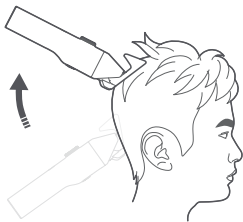

Go over multiple times with different lengths

### Notes

1. Using a comb helps prevent trimming hair too short by accident and control the overall length of the hairstyle.
2. Since hair tends to grow in different directions, the clipper must be moved (upwards/downwards/across) to keep it going against the direction of hair growth.
3. Trim repeatedly across the whole head to ensure the clipper catches all the hair to be trimmed.
4. Make sure the top of the comb stays in contact with the scalp to get an even trim.
5. For better results on curly, sparse or longer hair, brush the hair in the moving direction of the clipper.
6. Clean hair from the combs and blade heads to avoid them getting clogged and affecting the clipper's performance.
7. If the neck hole in the barber cape is too big or small, use a clip to adjust it.

## Using the thinning comb

The thinning comb will only cut half of the hair that goes through its teeth. It can be used to thin thicker hair and create a natural look.

1. Push the thinning comb into the comb slot to keep it close to the blade head.
2. Turn the clipper on and move it slowly against the direction of hair growth.

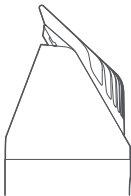

Thinning comb is close to the blade head

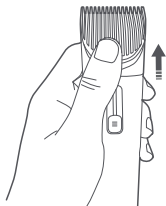

Push with your thumb to remove the thinning comb

## CAUTIONS

1. The adjustable combs will trim all hair in an area to the same length, while the thinning comb will only trim half the hair of this area. Make sure you understand this difference.
2. It is not recommended to use the thinning comb on very short hair.
3. Make sure to only use the thinning comb once in each area might get cut short.

## WARNING

### Using the adjustable head

Cutting blades may become hot after prolonged use.

1. When trimming the contours of the neck and sideburns, there's no need to use a comb. Instead, change the length of the adjustable head.
2. Rotate the adjustable head dial to change the length of the blade head. The number pointed by the arrow above the dial is the length of the hair left after trimming.
3. When trimming the contours of the neck sideburns, it is recommended to move the clipper slowly with its back facing up.

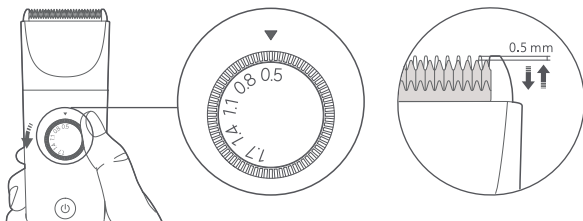

Setting the adjustable head



Trimming the contours of the neck and sideburns

## Care & Maintenance

---

### WARNING

Before cleaning and maintenance, the charging cable must be unplugged and the clipper must be turned off.

#### I. Cleaning the blade head and body

1. Remove the blade head.
2. Use the cleaning brush to remove any hair from the blade.
3. Rinse the blade head and body separately to remove all the hair.
4. Wipe with a cloth and leave to air dry.
5. Reattach the blade head to the clipper and store in a safe place.

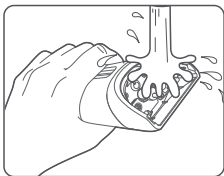
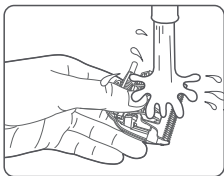
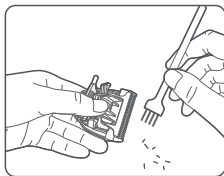

## CAUTIONS

- Rinse the blade head with clean water. Do not use salt water or hot water. Do not soak the clipper in water. After cleaning, be sure to dry the blade head to prevent the spring from getting rusted.
- Only clean the clipper with a soft cloth dipped in tap water or soapy water. Do not use paint thinner, gasoline, alcohol, or other chemicals.
- Never wash the charging cable.
- Never take apart the adjustable head or any other parts for cleaning, as they may not be able to be reassembled.
- The appliance is intended for trimming purpose only.

## II. Maintaining the blade head

As shown in the images, make sure to add lubricating oil (sold separately) to the spots shown before each use and after cleaning. Add 1 - 2 drops to each of the six spots shown.

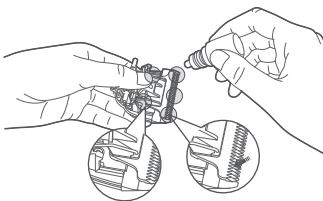

Adding oil to the blade head

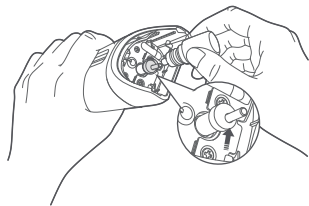

Adding oil to the motor

## Environmental Protection

---

When disposing of the clipper, do not throw it out with your household waste. Instead, take it to a government-designated recycling center, as this helps protect the environment.

## Specifications

Name	Xiaomi Hair Clipper
Model	LFQ04KL
Charging Time	2,5 hours
Working Voltage	3,7 V ===
Working Power	3 W
Rated Input	5 V === 1 A
Net Weight	266 g
Item Dimensions	47 x 45 x 182 mm

## Power Adapter

Information Published	Value and Precision
Manufacturer's Name	Jiangxi Jian Aohai Technology Co., Ltd.
Model Identifier	A520-050100U-EU1
Input Voltage	100 - 240 V ~
Input Frequency	50/60 Hz
Rated Output Voltage	5 V ===
Rated Output Current	1 A
Nominal Output Power	5 W
Average Active Efficiency	73,62 %
Efficiency at Low Load (10 %)	68,32 %
No-load Power Consumption	0,075 W

# Troubleshooting

Issues	Possible Causes	Solutions
The comb is wobbly.	The comb is not properly installed.	Reinstall the comb.
The motor is not working.	The battery is depleted.	Charge the battery.
	The motor is damaged.	Contact the after-sales service.
Hair isn't cut smoothly or is getting caught.	Using an unsuitable comb.	Choose a different comb.
	Blade head isn't lubricated.	Add lubricating oil to the blade head.
	Battery level is low.	Charge the battery.
The blade head doesn't move or shakes abnormally.	The blade head is damaged.	Replace the blade head.
	The blade head is not properly installed.	Reinstall the blade head.
	There are foreign objects in the blade head.	Clean the blade head.
Charging errors	The motor is damaged.	Contact the after-sales service.
	The charging cable is damaged.	Replace the charging cable.
	The battery is damaged.	Contact the after-sales service.
Working noise issues.	The blade head is not properly installed.	Reinstall the blade head.
	The blade head is damaged.	Replace the blade head.
	The motor is damaged.	Contact the after-sales service.



# WARRANTY NOTICE

---

THIS WARRANTY GIVES YOU SPECIFIC RIGHTS, AND YOU MAY HAVE OTHER RIGHTS CONVEYED BY LAWS OF YOUR COUNTRY, PROVINCE OR STATE. INDEED, IN SOME COUNTRIES, PROVINCES OR STATES, CONSUMER LAW MAY IMPOSE A MINIMUM WARRANTY PERIOD. OTHER THAN AS PERMITTED BY LAW, XIAOMI DOES NOT EXCLUDE, LIMIT OR SUSPEND OTHER RIGHTS YOU MAY HAVE. FOR A FULL UNDERSTANDING OF YOUR RIGHTS WE INVITE YOU TO CONSULT THE LAWS OF YOUR COUNTRY, PROVINCE OR STATE.

## 1. LIMITED PRODUCT WARRANTY

XIAOMI warrants that the Products are free from defects in materials and workmanship under normal use and use in accordance with the respective Product user manual, during the Warranty Period. The duration and conditions related to the legal warranties are provided by respective local laws.

For more information about the consumer warranty benefits, please refer to Xiaomi's official website <https://www.mi.com/en/service/warranty/>.

Xiaomi warrants to the original purchaser that its Xiaomi Product will be free from defects in materials and workmanship under normal use in the period mentioned above.

Xiaomi does not guarantee that the operation of the Product will be uninterrupted or error free.

Xiaomi is not liable for damages arising from non-compliance with the instructions related to the use of the Product.

## 2. REMEDIES

If a hardware defect is found and a valid claim is received by Xiaomi within the Warranty Period, Xiaomi will either (1) repair the product at no charge, (2) replace the product, or (3) refund the Product, excluding potential shipping costs.

## 3. HOW TO OBTAIN WARRANTY SERVICE

To obtain warranty service, you must deliver the Product, in its original packaging or similar packaging providing an equal degree of Product protection, to the address specified by Xiaomi. Except to the extent prohibited by applicable law, Xiaomi may require you to present proofs or proof of purchase and / or comply with registration requirements before receiving warranty service.

#### 4. EXCLUSIONS AND LIMITATIONS

Unless otherwise stipulated by Xiaomi, this Limited Warranty applies only to the Product manufactured by or for Xiaomi and identifiable by the trademarks, trade name or "Xiaomi" or "Mi" logo.

The Limited Warranty does not apply to any (a) Damage due to acts of nature or God, for example, Lightning strikes, tornadoes, flood, fire, earthquakes or other external causes; (b) Negligence; (c) Commercial use; (d) Alterations or modifications to any part of the Product; (e) Damage caused by use with non-Xiaomi products; (f) Damage caused by accident, abuse or misuse; (g) Damage caused by operating the Product outside the permitted or intended uses described by Xiaomi or with improper voltage or power supply or (h) Damage caused by service (including upgrades and expansions) performed by anyone who is not a representative of Xiaomi.

It is your responsibility to backup any data, software, or other materials you may have stored or preserved on the product. It is likely that the data, software or other materials in the equipment will be lost or reformatted during the service process, Xiaomi is not responsible for such damage or loss.

No Xiaomi reseller, agent, or employee is authorised to make any modification, extension, or addition to this Limited Warranty, If any term is held to be illegal or unenforceable, the legality or enforceability of the remaining terms shall not be affected or impaired.

Except as prohibited by laws or otherwise promised by Xiaomi, the after-sales services shall be limited to the country or region of the original purchase.

Products which were not duly imported and/or were not duly manufactured by Xiaomi and/or were not duly acquired from Xiaomi or a Xiaomi's official seller are not covered by the present warranties. As per applicable law you may benefit from warranties from the non-official retailer who sold the product. Therefore, Xiaomi invites you to contact the retailer from whom you purchased the product.

The present warranties do not apply in Hong Kong and Taiwan.

## 5. IMPLIED WARRANTIES

Except to the extent prohibited by applicable law, all implied warranties (including warranties of merchantability and fitness for a particular purpose) will have a limited duration up to a maximum duration of this limited warranty. Some jurisdictions do not allow limitations on the duration of an implied warranty, so the above limitation will not be applied in these cases.

## 6. DAMAGE LIMITATION

Except to the extent prohibited by applicable law, Xiaomi shall not be liable for any damages caused by accidents, indirect, special or consequential damages, including but not limited to loss of profits, revenue or data, damages resulting from any breach of express or implied warranty or condition, or under any other legal theory, even if Xiaomi has been informed of the possibility of such damages. Some jurisdictions do not allow the exclusion or limitation of special, indirect, or consequential damages, so the above limitation or exclusion may not apply to you.

## 7. XIAOMI CONTACTS

For customers, please visit the website:

<https://www.mi.com/en/service/warranty/>

The contact person for the after-sale service may be any person in Xiaomi's authorized service network, Xiaomi's authorised distributors or the final vendor who sold the products to you. If in doubt please contact the relevant person as Xiaomi may identify.

Importer:

Beryko s.r.o.

Pod Vinicemi 931/2, 301 00 Plzeň

[www.beryko.cz](http://www.beryko.cz)

Manufactured for: Xiaomi Communications Co., Ltd.

Manufactured by: Shenzhen Kolamama Technology Co., Ltd.

Address: Room 705, Building 1, Xinyi Lingyu R&D Center, No. 30, Honglang North 2nd Road Zone 69, Xingdong Community, Xin'an Street, Bao'an District, Shenzhen City, Guangdong Province, China

For further information, please go to [www.mi.com](http://www.mi.com)

For detailed e-manual, please go to [www.mi.com/global/service/userguide](http://www.mi.com/global/service/userguide)

User Manual Version: V1.0